



SERVICE BULLETIN

NUMBER: SB 500-34-021, REV A
MODEL: ECLIPSE EA500
SUBJECT: STATIC DRAIN LINE INSPECTION FOR PROTECTIVE CAPS

1. PLANNING INFORMATION

A. Effectivity

Aircraft Serial Numbers 000001-000258.

B. Reason

Static port drain lines have been discovered with protective caps installed on the end of the tubing. The protective caps prevent proper draining of the static port drain lines.

C. Description

This Service Bulletin (SB) provides inspection procedures of the static port drain lines for protective caps on the ends of the tubing and removes those protective caps if found.

D. Compliance

Eclipse Aviation Corporation considers this to be a required inspection that must be accomplished within 24 months from the issue date of this Service Bulletin or concurrent with the next 300 hour inspection.

E. Approval

This Service Bulletin is based on engineering data that is FAA-approved, and the inspection herein complies with the applicable regulations.

F. Labor Requirements

The following information is for planning purposes only.

(1) Estimated labor hours to perform:

Suggested number of personnel: 1

Task name: Job Set-Up: 1 Hour

Task name: Inspection: 0.25 Hour

Job Close-Up: 1 Hour

Total labor hours: 2.25 Hours

The above is an estimate based on properly equipped and experienced personnel complying with this Service Bulletin. Actual labor hours may vary depending on workforce experience, concurrent maintenance, discovery of other discrepancies, etc.

(2) Qualification of personnel:

- A person properly authorized under 14 CFR 43 to perform aircraft maintenance.



SERVICE BULLETIN

G. Weight and Balance Change

None

H. Electrical Load Data Change

None

I. Software Accomplishment Summary

None

J. References

Aircraft Maintenance Manual (AMM) P/N 06-117751, latest revision.

K. Publications Affected

None

2. MATERIAL INFORMATION

A. Materials

No materials are required for this SB.

B. Tooling

The following special tooling/support equipment is required to accomplish this Service Bulletin.

Nomenclature	Specification	Use
Seat Foot Release Cable Tool	EAC, 9000-2521275	To assist seat removal

C. Interchangeability/Intermixability of Parts

None

D. Part Re-identification

None.

3. ACCOMPLISHMENT INSTRUCTIONS

A. Job Set-Up

- (1) Make aircraft safe for maintenance. Refer to AMM 20-00-01 MAKE SAFE FOR MAINTENANCE.
- (2) Remove pilot's seat. Refer to AMM 25 11-10 COCKPIT SEAT - REMOVAL.

B. Inspection

- (1) Inspect ends of the static drain lines for plastic protective caps refer to [\(Detail A, Figure 1\)](#). Static drain lines are located forward of pilots rudder pedals.
- (2) If caps are found, remove caps from static drain lines. Discard caps.
NOTE: Protective caps pull off.
NOTE: May remove floorboard if required for access. Refer to AMM 25-11-30 COCKPIT FLOOR PANEL-REMOVAL.
- (3) Drain static lines. Refer to AMM 34-10-00 FLIGHT ENVIRONMENT DATA - SERVICING, Static Port Drain Procedure



ECLIPSE
AVIATION

REQUIRED

SERVICE BULLETIN

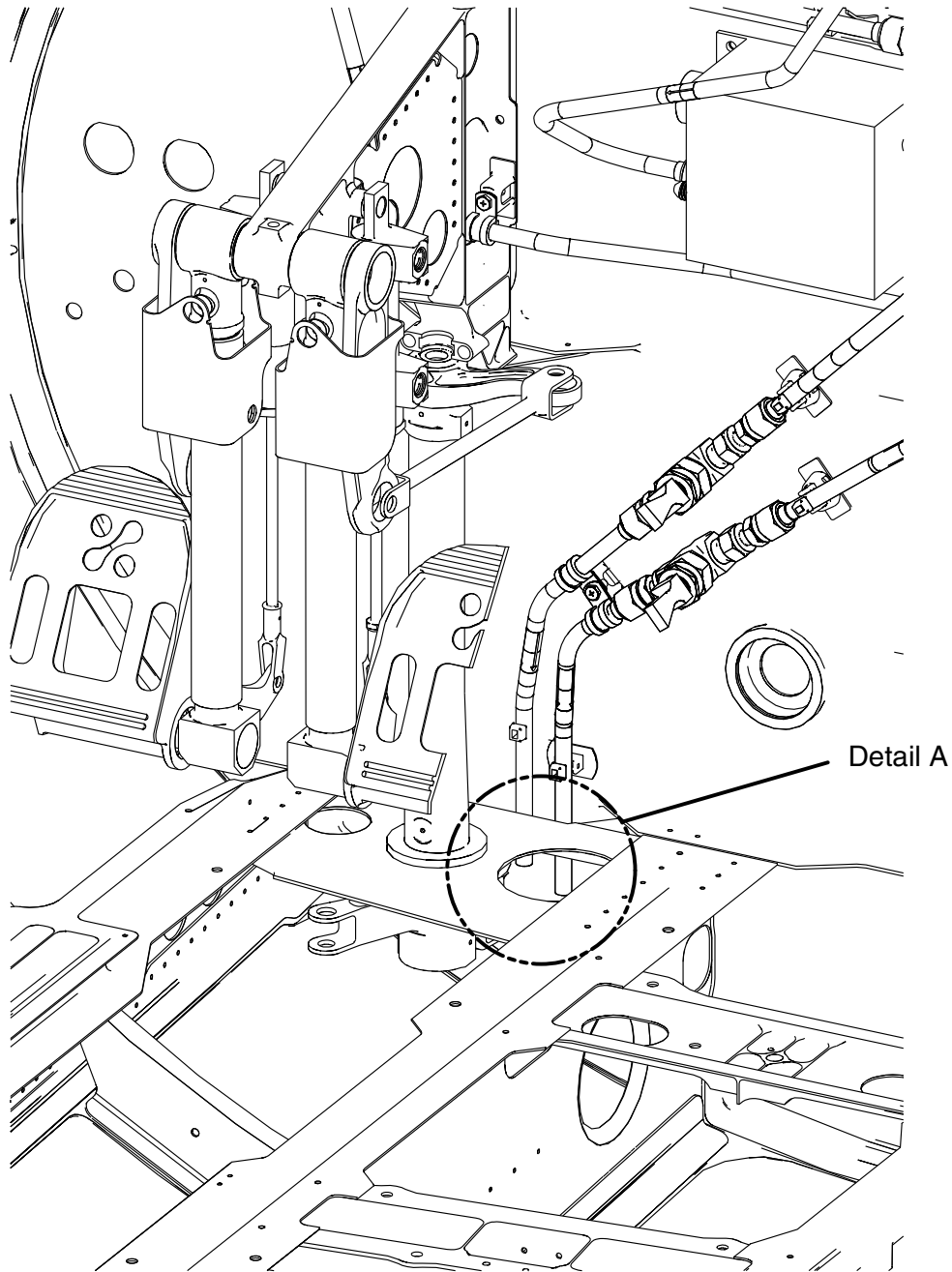

**Static Drain Lines
Figure 1**

5081163A



SERVICE BULLETIN

C. Job Close-Up

- (1) Remove all tools, equipment and unwanted material from work area.
- (2) Install pilot's seat. Refer to AMM 25-11-10 COCKPIT SEAT - INSTALLATION
- (3) Install floor board if removed. Refer to AMM 25-11-30 COCKPIT FLOOR PANEL-INSTALLATION.
- (4) If all other maintenance is complete, return aircraft to service. Refer to AMM 20-00-02 RETURN TO SERVICE (AFTER MAINTENANCE).

D. Limitations and Procedures

None

E. Parts Disposition

N/A

F. Cost

Materials and Labor will be supplied by Eclipse Aviation Corporation at no charge to the aircraft owner if accomplished at an Eclipse Aviation Service Center or authorized Eclipse Aviation Service Center. Contact Eclipse Aviation Customer Care for questions.

4. RECORD OF COMPLIANCE

Upon completion of this Service Bulletin, make an appropriate maintenance-record entry specifying the Service Bulletin number.

5. NOTIFYING ECLIPSE AVIATION

On completion of this Service Bulletin, the operator/maintainer shall complete the attached Compliance Record and send it to Eclipse Aviation via regular mail, fax, or e-mail.

MAILING ADDRESS	Eclipse Aviation Corporation ATTN: Customer Care 2503 Clark Carr Loop SE Albuquerque, NM 87106
Fax	1-505-241-8802
E-mail	customer care@EclipseAviation.com

